

# NiceHome System

Catalogue 2011

Integrated management of home alarm  
and automation systems.

**Nice**

Home Automation

Be  
Bə

# Nice Different



Catalogue 2011

# NiceHome System

6 21	Nice Overview
22 55	NiceHome range
30	Kit solutions
32 35	Control units
36 37	Sirens
38 41	Control systems
42 49	Detectors and accessories

# I'm Nice

## Home integrated solutions.

Ease of use, aesthetic quality, safety.



for alarm  
systems



for awnings, blinds  
and rolling shutters



for rolling  
doors



“Nice has suggested a new interpretation of the connection between people and their domestic environment marked by the utmost simplicity, clearness and aesthetic quality. Boring and complicated operations become smooth and amusing and change into activities that satisfy end-users...”

From Il Sole 24 Ore - Speciale Nova, by Marco Bettiol and Stefano Micelli, 1<sup>st</sup> February 2007

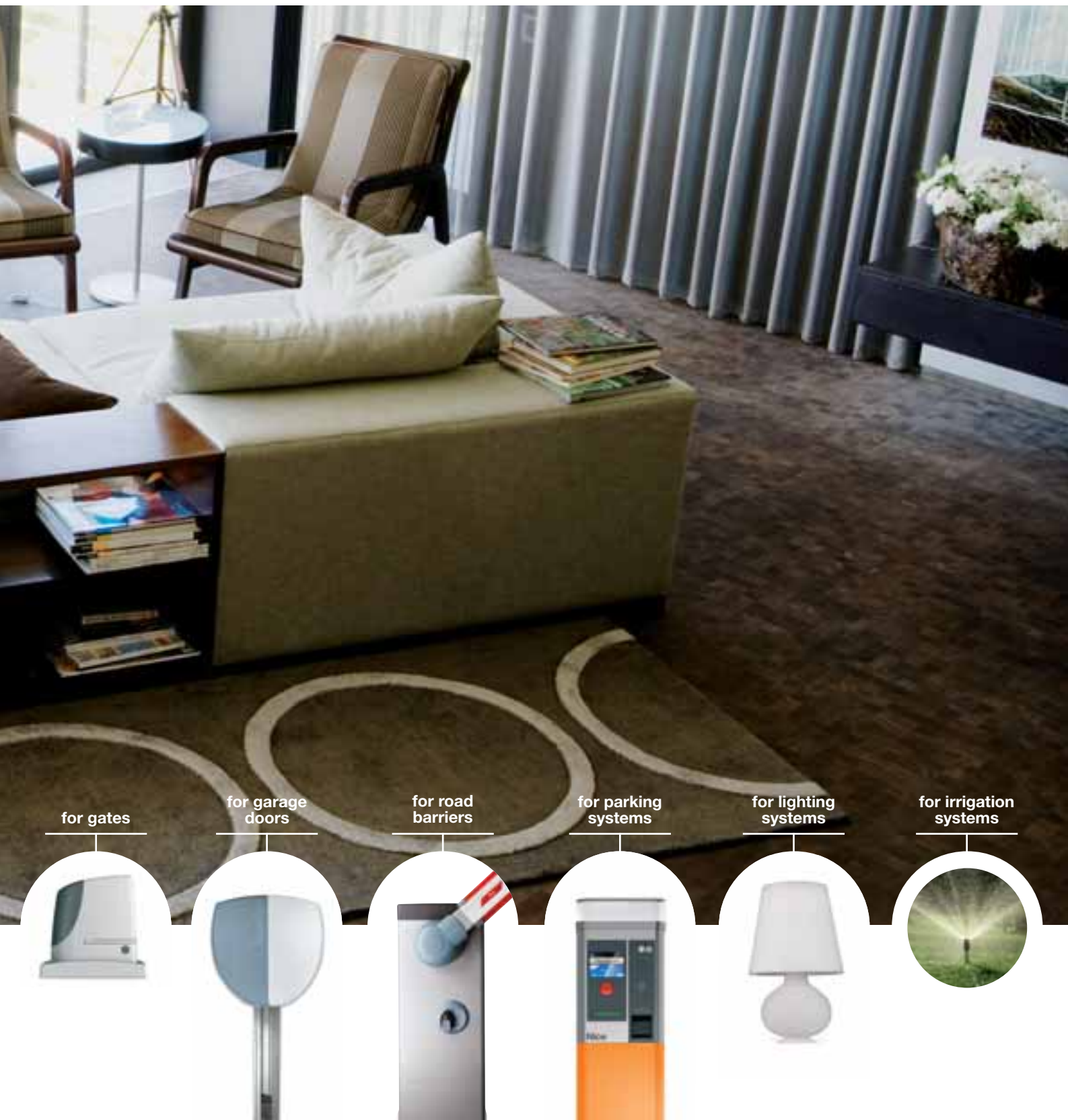



# The Nice History

The world of home automation systems can be divided into the world before and after Nice: many solutions which are now widespread, were actually introduced by Nice and - only later - used by other manufacturers; many are Nice exclusives and protected by numerous patents. In the following pages we will introduce some of them.

## 1995

### **Handy design: effortless and with only one hand.**

In its first generation of motors, Nice had already conceived unlocking mechanisms made of simple keys, easy to activate with only one hand.

This meant that there would no longer be any waiting under the rain, physical effort, or painstaking research for a key which could not be found while needing to get into the house with your hands full of shopping bags or while carrying a baby.



## 1993

### **Nice Products.**

With Nice, transmitters become objects to show: functional, powerful but miniaturized and elegant.

The transmitter itself, seen in a car or attached to a friend's key ring, becomes Nice's first way of communication, pulling an immediate request from the bottom through the most effective media: the word-of-mouth.





## 2003

### **BUS systems: much more simplicity.**

In 2003 Nice launched the BlueBUS on the market, which changed the concept of automation by making installation really easy and quick: nothing but two wires now connect all the system devices, which can be amplified later with the same simplicity. The absence of polarity and clamps, which can be identified thanks to the use of different colours and serigraphies, make the connection even easier and really error-free.





**2005**

**The modular control:  
choice and rationality.**

Nice goes beyond the idea of finished products, introducing the concept of modularity: a wide product range always available, with no problem of warehouse management.

Is an innovative technology that supersedes the concept of the finished product, creating a wide range of personalised products through the assembly of complimentary and interchangeable parts.

## 2007

### **Opera marks the future of the automation.**

The innovative system Nice Opera makes the work for the installer easier thanks to the remote control of any automation system via PC, PDA, while customers can manage home automation via mobile or Smartphone.



# NiceToday

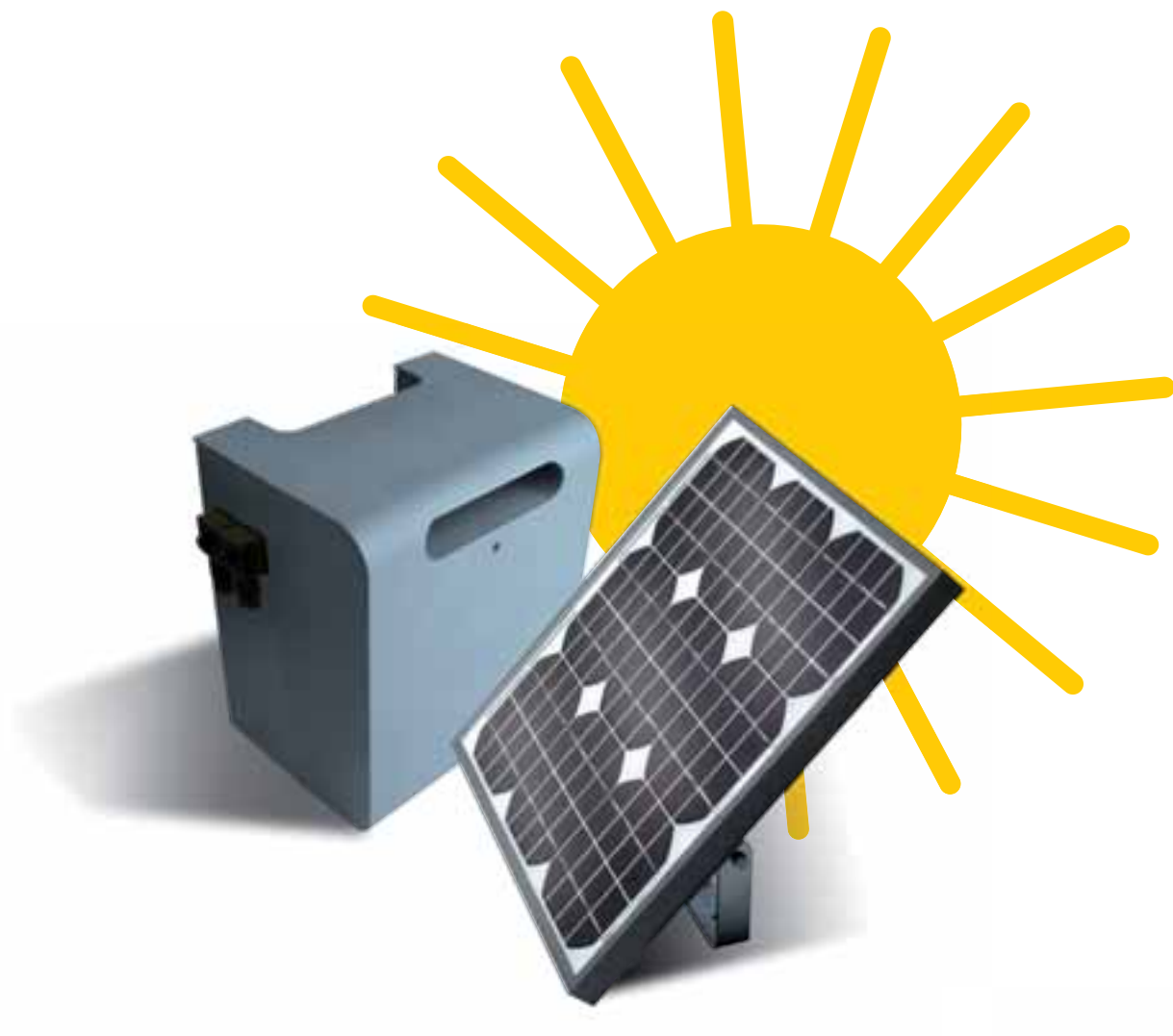

## Energy in nature

**NRC and Solemyo =  
no waste of time, no masonry!**

Solar power allows to install automation even far away from any electrical network.

The application of wireless technology with Nice Radio Connection (NRC system) avoids the cost and the inconvenience of unsightly wiring ducts for control wires.

Thanks to NRC and Solemyo, Nice makes the installation process much easier and convenient, especially for already existing buildings which allows to eliminate any hindrance to the diffusion of automation systems.

An ecological and extremely intelligent system which allows the final user to make a notable economic saving!





## Total Control

### **With just a touch, total control.**

With Nice you can control the whole range of automations for gates, garages, awnings and rolling shutters, alarm systems as well as irrigation, lighting systems and electrical loads. All are always under control!

## Home Security

### **NiceHome System, security combines with automation.**

The NiceHome System combines Nice control devices simplicity and completeness with the professionalism of the alarm systems the group companies have developed according to their 30-year experience.

Apart from the alarm systems, the user can directly manage up to 18 controls for automation, illumination and electrical loads.

Everything with a 100% wireless solution: maximum safety with maximum ease.

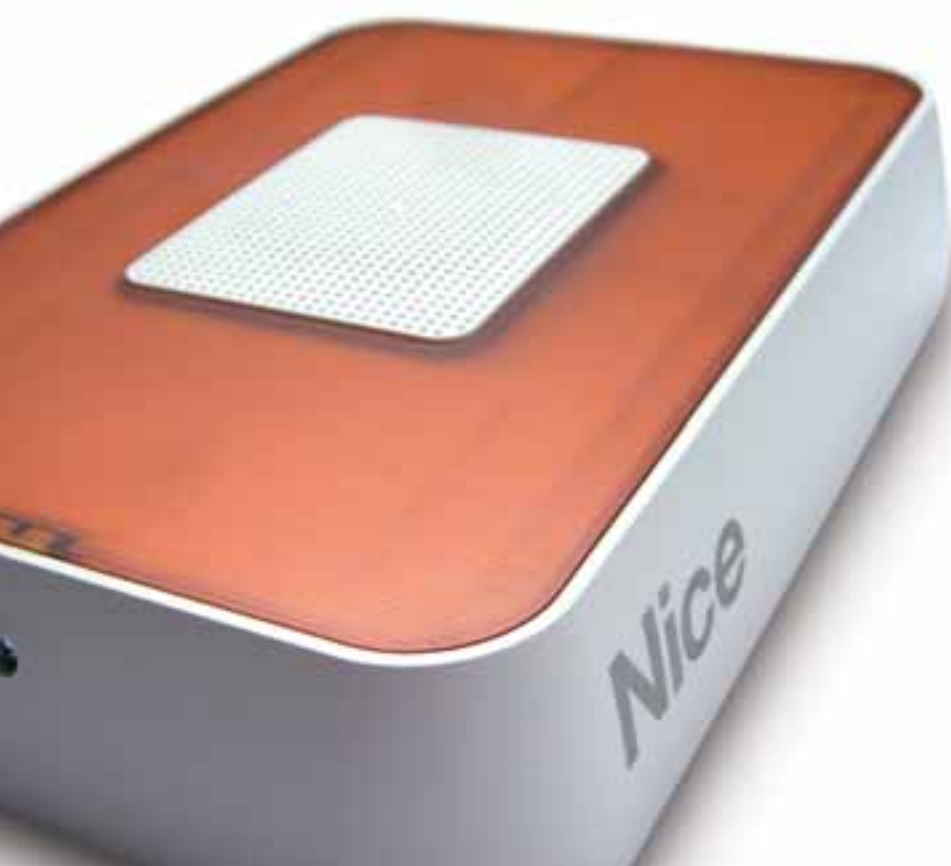

The security of going  
in and out in total freedom,  
by meeting the desire  
of comfort with practical  
products and an emotional  
design, in order to experience  
the most of the housing space:  
this is the Nice mission.

# Designing a **Nice** World

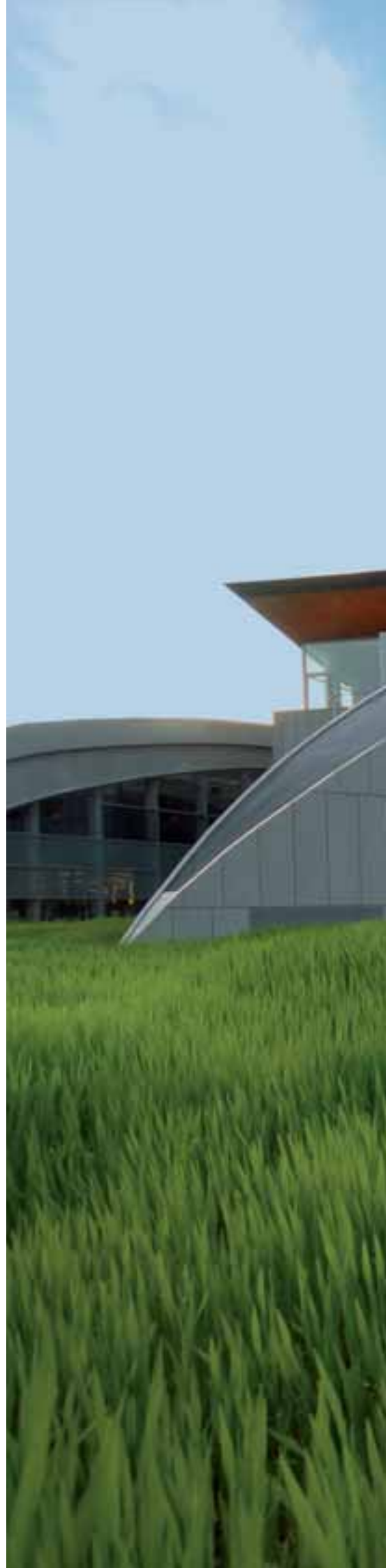





## Nice Headquarters



Nice is movement:  
humans have been placed  
in the centre of the building

Project Architectural  
by Studio Carlo Dal Bo

## Nice meets Art



Lighting sculptures  
by Jacopo Foggini

Multimedia installation  
by Limiteazero + Cristina Chiappini





**Be Extreme  
Be Nice**



For the sense of freedom  
living close to nature,  
the team effort, the ability  
to handle the unpredictable,  
**Nice has decided to take  
part in the frontline  
of the Extreme 40 circuit.**

[www.nicesailingteam.com](http://www.nicesailingteam.com)





## Nice Centre for Technology



Tests and controls are carried out in our internal laboratory, in order to guarantee the reliability of the products and increasingly higher quality levels



## Nice Rider



Mobile and automated  
expositive structure  
by Roberto Gherlenda



“We want to do something tangible for those who need special attention”



FOR EVERYONE  
EVERYWHERE  
LIBERTY



Nice F.e.e.l.



Photo by  
Laura Bot





## Nice Design

Constant research into new shapes and materials. Study of colour. High-tech solutions with a simple and elegant design

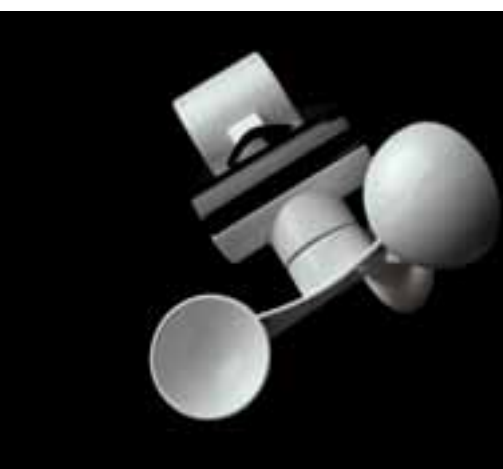

The first company in this field believing in the importance of design; over the years Nice products have received great international acclaim



2000  
"International  
Design Gallery"  
Expo 2000  
Hannover

**ADI**

2001  
Best of Category  
"Design for the  
Environment"  
XIX Compasso  
d'Oro



2002  
Permanent  
Collection  
at The Museum  
of Design



1999, 2003,  
2005  
"Intel Design  
Award"



1999, 2003,  
2005  
"ADI Design  
Index"



2005  
"Trophée  
d'Argent"  
Trophée  
du Design  
Batimat



2006  
"Innovation Prize"  
R+T Stuttgart



2007  
"Innovation &  
Design Award"  
LivinLuce



2008  
"Grandesign Etico  
International Award"



Nice

“For every job it is a question  
of attention, a lot of attention ...  
in other words it’s a question of love”

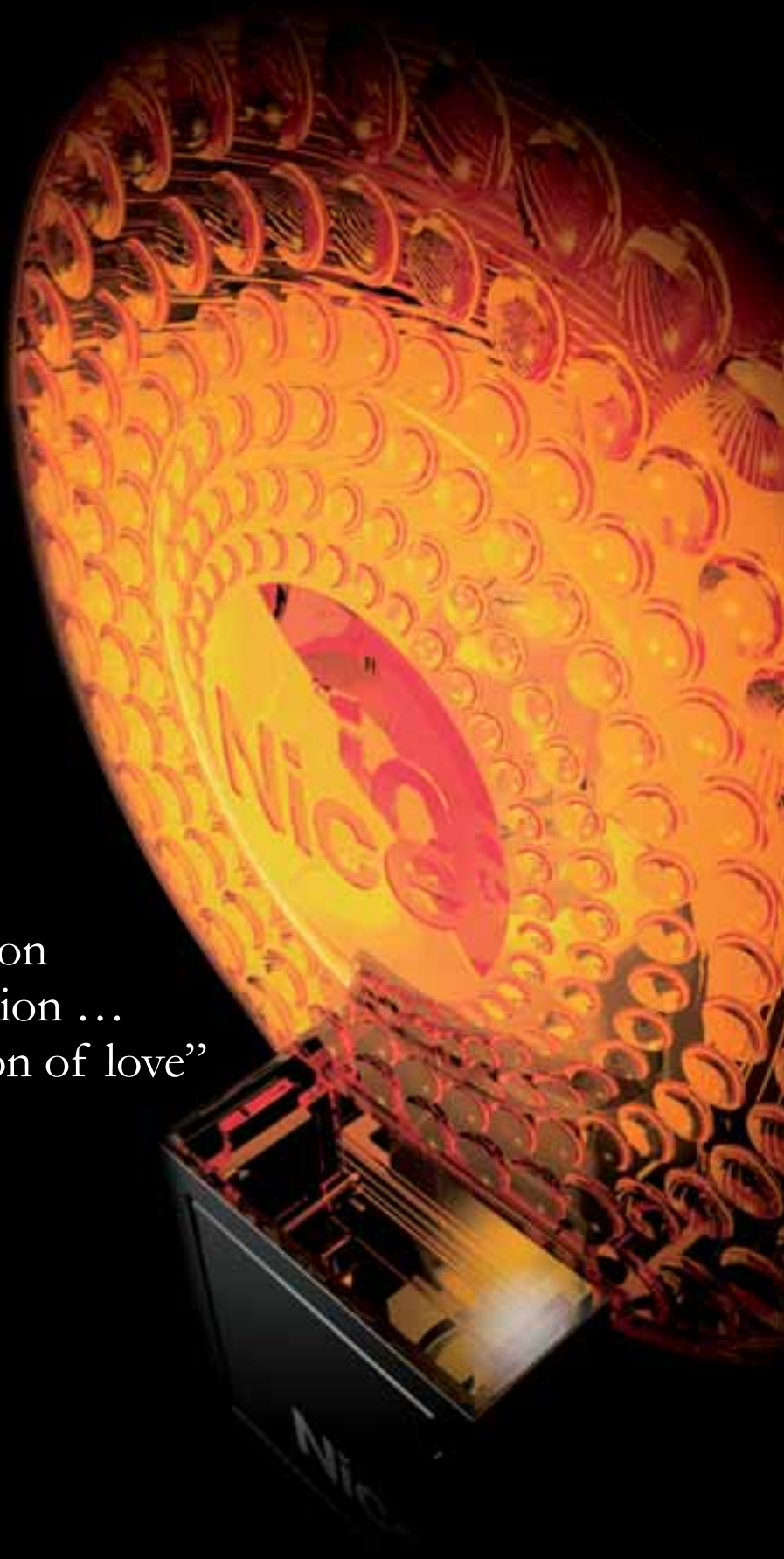

# NiceHome System



# NiceHome range

30	Kit solutions
32 35	Control units
36 37	Sirens
38 41	Control systems
42 56	Detectors and accessories

# Control of the home by a simple click: alarm systems and integrated management of home automations, together.

NiceHome is a complete system, equipped with all provisions to protect the home and its occupants, and to enable simple management of all home automations.



## Professional alarm system and simplified management of home automations.

### Just a click away!

NiceHome is the latest result in thirty years experience in the sector of professional wireless alarm systems of all companies in the Nice Group. NiceHome offers targeted solutions for the specific market with the ability to control Nice automation systems, lighting and irrigation systems, and all electrical loads.



## Bidirectional transmission

NiceHome confirms the execution of any commands with an acoustic or visual signal on the control unit and on the outdoor siren, with illumination of a led on the remote controls or via an SMS text message.

### Self-diagnostics

NiceHome continuously supervises the efficiency of communication between all components of the system, guaranteeing perfect operation and signalling any faults.



## Voice messages

The personalisable deterrent messages emitted by the siren and NiceHome control units in the protected area give advance warning of effective activation of the alarm, proving to be highly useful in discouraging break-in attempts, which, even if avoided by subsequent alarm activation, still cause damage by forced entry.



## Protection by similar areas

Portable 4 or 8 channel control units and commands enable users to turn all three or single zones on and off as required. The division by zone may involve uniform blocks, and is useful when protection of part of the home is required, while being able to continue with normal activities in zones where the alarm is inhibited (for example: Zone A, ground floor rooms; Zone B, first floor rooms; Zone C, the garage).





## Everything under control, even at a distance

You can call the NiceHome control unit remotely to check status via a GSM network or PSTN line. NiceHome differentiates signals of attempts at approach, forced entry or breakage of doors/windows, intrusion, incipient fires or flooding, and other abnormal or potentially hazardous events. Ambient listening function.



## The system informs you

The non volatile memory of the system records the last 200 events. Opening sensors signal attempts at break-in, volumetric sensors indicate the presence of intruders in rooms: all signals with the control unit activated generate an alarm and telephone call and/or SMS text message specifying the detector that generated the alarm.



## Reassurance, at all times

More reassurance with the anti-duress and anti-aggression functions: the first inhibits activation of the alarm systems by simulating system deactivation, while transmitting a direct call to the police forces or any other set number as required. The second activates the outdoor sirens by pressing a key on the remote control.

The NiceHome emergency call enables programming of a direct call to the telephone numbers in the phone book, to transmit a personalised message - voice or text - with a request for help.

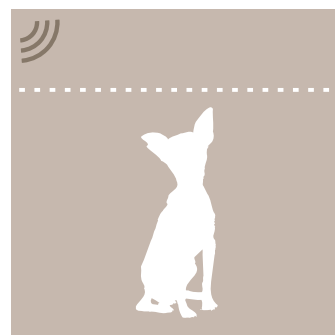

## “Pet Immunity” Function

The NiceHome HSDIM11 presence detectors enable the user to make a simple setting to obtain Pet Immunity detection; the presence of small animals thus no longer trips the alarm: even more practical, at no extra expense.

# Wireless or wired, NiceHome is always easy to install, program and use.

Totally wireless and mixed wired/via radio solutions, guarantee maximum flexibility of installation, even where wiring is not possible.

The set-up of a “made-to-measure” system is now easier than ever, to meet all the needs for protection and comfort in the home!

**Control and programming keypad**  
with backlit LCD display  
to display all events  
and programming  
of the control unit

**Voice warnings**  
pre-recorded and  
personalisable with a deterrent  
function or as a guide  
to installation and use

**Microphone for ambient control** and recording  
of voice messages

**PSTN and GSM diallers**  
for dual safety, remote  
querying and control,  
warnings via SMS text  
messages, telesurveillance  
and remote assistance

**Powerful siren**

## Mains power plus rechargeable batteries

Prolonged lifetime and guaranteed operation even in the event of a power failure



## Easy and quick intervention:

all elements protected in a removable box

## All the safety you need, and more

The anti-removal systems are activated on each unauthorised intervention; the integrated GSM telephone dialler and siren also work in the event of a power failure or if electrical or telephone lines are cut

# Tranquillity and comfort: the NiceHome solutions to manage, deter, protect and warn.

Prevention is obviously the ideal solution: on the NiceHome system you will find all solutions to deter undesired events and to limit the consequences. A house with NiceHome is also home with so much more comfort.

## 1. Integrated management

**Control units for alarm systems, Dual Band via radio and mixed, wired and via radio, bidirectional with GSM telephone dialler.**

As well as alarm systems, NiceHome control units can control up to 16 automations or groups of automations, assigning each with the times and ways of use as required.



**Miniaturised recessed receivers**, for management via radio of all commands sent by the system



**Rolling shutters**



**Lighting systems**



**Irrigation systems**



## 2. Deterrence and warning



**Alarm sirens**  
for outdoors via radio and with wired connection to the Dual Band control unit, with integrated flashing light



**Siren**  
via radio for indoors

## 3. Local management



**Transmitter**  
8 channel with four programmable keys: automations, lighting, irrigation etc.



**Transmitter**  
4-channel



**Control key-pad**,  
wall-mounted or portable

## 4. Remote management



**Voice and text messages**



**Modem**  
for teleservices

A new concept in protection for the homes of today. NiceHome enables protection of the area, dividing it according to the exclusive logic of “concentric circles”.

Deterrence thanks to the voice messages emitted by the sirens against attempts at intrusion before they even start (**Zone A**). Activation of sirens on the first attempt at break-ins through doors or windows (**Zone B**). Calls to the police forces only when indoor detectors (**Zone C**) signal effective intrusion in the rest of the home.

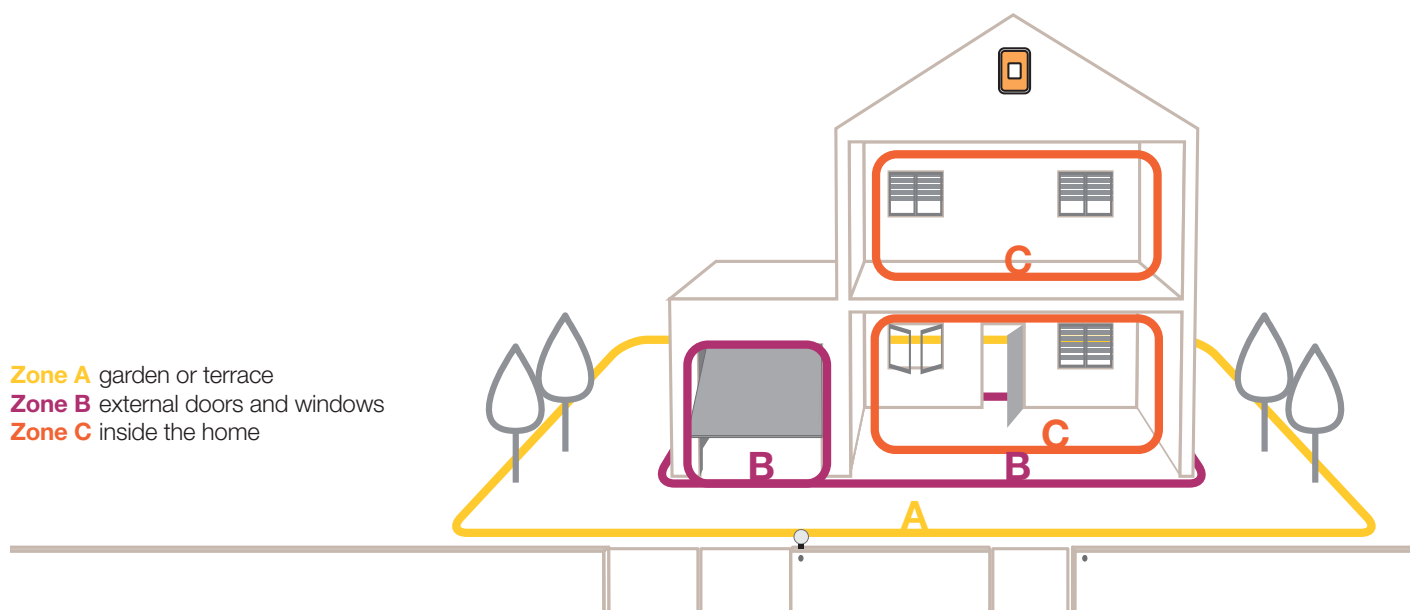

## 5. Safety and protection



Detector with magnetic contact, to indicate opening of doors and windows



Infrared detector with volumetric lens, to indicate any movements in the protected area



Infrared detector with vertical curtain lens, to protect doors and windows



Infrared detector with volumetric lens or dual technology, via radio, detects any movement in the protected area



Volumetric dual technology detector, via radio, for outdoor use



Volumetric detector of glass breakage



Fine volatile powder detector



Flood detector sensor



## Kit

Select the kit that suits you on the basis of the control unit characteristics!



### HSKIT1W

with control unit **via radio**  
battery-powered,  
and **PSTN** telephone dialler

### HSKIT1GW

with control unit **via radio**  
battery-powered,  
and **PSTN** and **GSM** telephone dialler

### HSKIT1GC

with control unit **via radio + cable**, 230 Vac,  
and **PSTN** and **GSM** telephone dialler

## +

### Accessories included in every kit:



#### 1 HSTX4

4-channel transmitter,  
rolling code, total and partial  
activation, emergency, anti-panic.



#### 1 HSDID11

Opening detector  
with magnetic contact.



#### 1 HSDIM11

Infrared volumetric detector  
with corner support.

Code	Description
<b>HSKIT1W</b>	Kit for installation of an alarm system <b>via radio</b> , <b>with control unit (HSCU1) equipped with PSTN telephone dialler</b>
<b>HSKIT1GW</b>	Kit for installation of an alarm system <b>via radio</b> , <b>with control unit (HSCU1G) equipped with PSTN and GSM telephone dialler</b>
<b>HSKIT1GC</b>	Kit for installation of an alarm system <b>wired and via radio</b> , <b>with control unit (HSCU1GC) equipped with PSTN and GSM telephone dialler</b> . Optional back-up battery B12V-C

**N.B.** The content of the package may vary: consult the retailer.

The NiceHome kits are the most comprehensive solution for the installation of residential alarm systems, integrated with anti-hazard and automation management functions.

**Wireless freedom:** totally wireless and mixed wired/via radio solutions, guarantee maximum flexibility of installation, even where wiring is not possible.

The set-up of a "made-to-measure" system is now easier than ever, to meet all the needs for protection and comfort in the home!

#### Deterrence, protection, warning

"Talking" control unit including personalisable warnings, voice guide and 106 dB siren with a powerful deterrent effect.

Differentiated management of alarms provides different signals to indicate approach, tampering, forced entry or break-ins through windows or doors, intrusion into protected areas, incipient fires or floods and other hazardous events. In the event of an alarm the control unit calls the programmed telephone numbers, transmitting specific messages associated with the event.

#### Reassurance, at all times:

thanks to Dual Band radio transmission (433 and 868 MHz) and bidirectional devices, the system is supervised and also indicates the presence of radio disturbance.

**Remote control:** everything under control, even at a distance PSTN and GSM diallers (HSKIT1GC e HSKIT1GW) for dual safety, remote querying and control, warnings via voice and text messages, telesurveillance and remote assistance.

In less than optimal GSM coverage conditions, the control unit can be connected to an external antenna, thanks to the **new SMA connector**.

**No Black-out;** guaranteed operation in the event of a power failure and warning via text message.



Wireless  
((( )))

**3**  
Areas

Included  
+ +  
+ +

Dual Band  
**433 MHz**  
**868 MHz**

Siren  
**106 dB**

**Nice**  
Design



# Nice HSCU Wireless control units



**Supervised and remotely controlled control units, battery-powered for dual band bidirectional alarm systems via radio.**

**Maximum flexibility:** the HSCU Wireless control unit is the ideal solution for residential alarm systems, integrated with anti-hazard and home automation functions without the need to lay cables and completely independent from the electrical mains.

**Maximum safety:** supervised Dual Band radio transmission and control of radio interference ensure safe communication between the control unit, detectors and alarm devices.

**Total and differentiated management** of alarms provides different signals to indicate approach, tampering, forced entry or break-ins through windows or doors, intrusion into protected areas, incipient fires or floods and other hazardous events.

In the event of an alarm the control unit calls the programmed telephone numbers, transmitting specific messages associated with the event.

The user can call the control unit (only via the PSTN land line) to check and modify status as required, listen to ambient noise and activate electrical utilities, lights, automations, boilers etc.

The HSCU wireless control unit answers in a clear voice, confirming and/or notifying of new events.

**Deterrence and warning:** the deterrent effect of the system is guaranteed by powerful indoor and/or outdoor sirens, also warning by means of vocal synthesis, light activation and activation of other deterrent devices.

**Integrated 106 dB siren,** with mute option, and low intensity buzzer.

Running on a Battery Pack, the control unit can control up to 99 radio peripherals and a wide variety of alarm devices (sirens and various receivers).

**Everything under control:** the **HSCU1GEN** control unit enables 16 radio controls for activation of home automations with the option for remote control via a telephone connection (PSTN); it works on the land line and GSM network, calling up to 63 telephone numbers, to which it can send up to 6 voice messages, 14 text messages (including 6 personalisable), as well as digital protocols if connected to an alarm receiving centre.

In less than optimal GSM coverage conditions, the control unit can be connected to an external antenna, thanks to the **new SMA connector**.

Code	Description
<b>HSCU1GEN</b>	Control unit for alarm systems via radio, Battery-Pack powered (supplied). Equipped with PSTN and GSM telephone diallers
<b>HSCU1EN</b>	Control unit for alarm systems via radio, Battery-Pack powered (supplied). Equipped with PSTN telephone dialler
<b>HSPS1</b>	Battery Pack 9 V (12 Ah)
<b>HSA1</b>	Cable and software for direct Control unit-PC connection
<b>HSA2</b>	Telephone line splitter, with RJ11 output and terminal

## Technical specifications

Code	HSCU1GEN	HSCU1EN
Power supply	Battery Pack 9 V (12 Ah), supplied	
Autonomy	Approx. 2 years*	
Alarm via radio inputs	Up to 99 programmable detectors: immediate, delayed or AND, on 3 activation zones A-B-C or in three 24-hour zones: panic, robbery, technical alarm	
Anti-tamper via radio	Reception of tamper signal from each detector; reception of supervision and low battery signals	
Alarm via radio outputs	Digital transmission encoded at 72 bit, for alarm device control	
Radio system control	Continuous, simultaneous and programmable control of 2 working frequencies	
Event log	Last 200 events	
Timers	<ul style="list-style-type: none"> <li>- Programmable delayed activation - Programmable delay on each detector</li> <li>- General alarm direction of 3 cycles each of 3 minutes at intervals of 3 minutes</li> </ul>	
Displays	Display of 2x16 characters, with possibility of naming each peripheral (label)	
Commands	Alphanumeric keypad, 20 keys	
Sound power	Alarm siren 106 dB + buzzer with low intensity signal function	
Acoustic signals	Recordable voice messages for main communication guidelines for the user	
Vocal synthesis	Vocal synthesis with 125 pre-recorded "phrases", available in the main languages	
Radio reception/transmission	Digital bidirectional communication, on dual band frequency (433 and 868 MHz)	
Radio range	100 m in open field free of disturbance or approx. 20 m inside buildings	
Wired connection	PSTN land line (also with broadband)	
GSM module**	Quad-band, GSM 850/900/1800/1900 MHz	
Operating temperature	-10 ÷ +40 °C	
Dimensions (LxDxH)	211x54x307 mm	
Weight	2 kg	

\*It may vary according to the use and type of system. \*\*Only for HSCU1G version.



The box that protects the control electronics, removable and rotary to facilitate maintenance and access to the memory and SIM card of the GSM versions.

# Nice HSCU Control units



## Supervised control units with remote control for mixed Dual Band and wired alarm systems via radio.

The HSCU **control unit** is the most comprehensive solution for the installation of residential alarm systems, integrated with anti-hazard and automation management functions.

**Maximum safety:** supervised Dual Band radio transmission and control of radio interference ensure safe communication between the control unit, detectors and alarm devices.

**Total and differentiated management** of alarms provides different signals to indicate approach, tampering, forced entry or break-ins through windows or doors, intrusion into protected areas, incipient fires or floods and other hazardous events.

In the event of an alarm the control unit calls the programmed telephone numbers, transmitting specific messages associated with the event.

The user can call the control unit to check and modify status as required, listen to ambient noise and activate electrical utilities, lights, automations, boilers etc.

The HSCU control unit answers in a clear voice, confirming and/or notifying of new events.

**Deterrence and warning:** the deterrent effect of the system is guaranteed by powerful indoor and/or outdoor sirens, also warning by means of vocal synthesis, light activation and activation of other deterrent devices.

**Integrated 106 dB siren,** with mute option, and low intensity buzzer.

Power at 230 Vac, the control unit can control up to 99 radio peripherals and up to 6 wired detectors with dedicated power supply; it is equipped with radio/wired outputs for alarm devices and for 18 home automation commands (16 radio commands + 2 relays).

**No black-out:** the backup battery (optional) enhances system safety, guaranteeing operation in the event of a power failure.

**Everything under control:** the **HSCU1GCEN** control unit works on the land line and GSM network, calling up to 63 telephone numbers, to which it can send up to 6 voice messages, 17 text messages (including 6 personalisable), as well as digital protocols if connected to an alarm receiving centre.

In less than optimal GSM coverage conditions, the control unit can be connected to an external antenna, thanks to the **new SMA connector**.

Code	Description
<b>HSCU1GCEN</b>	Control unit for mixed, wired and radio-controlled alarm systems, powered at 230 Vac and lead battery (not supplied). Equipped with PSTN and GSM telephone diallers
<b>HSCU1CEN</b>	Control unit for mixed, wired and radio-controlled alarm systems, powered at 230 Vac and lead battery (not supplied). Equipped with PSTN telephone dialler
<b>B12V-C</b>	12 V lead battery (2.2 Ah) required as Backup for control units powered at 230 V
<b>HSA1</b>	Cable and software for direct Control unit-PC connection
<b>HSA2</b>	Telephone line splitter, with RJ11 output and terminal



## Technical specifications

Code	HSCU1GCEN	HSCU1CEN
Power supply	230 Vac 50 Hz	
Backup battery	Rechargeable lead 12 V 2.2 Ah, autonomy without mains 36 h ± (not supplied)	
Power supply output	12 Vdc output (nominal) maximum 1.2 A	
Alarm via radio inputs	Up to 99 programmable detectors: immediate, delayed or AND, on 3 activation zones A-B-C or in three 24-hour zones: panic, robbery, technical alarm	
Wired alarm inputs	6 NC lines, freely programmable on the 3 activation zones A-B-C	
Anti-tamper via radio	Reception of tamper signal from each detector; reception of supervision and low battery signals	
Wired anti-tamper device	3 Tamper NC lines (zones A-B-C) and control unit opening/detachment protection	
Alarm via radio outputs	Digital transmission encoded at 72 bit, for alarm device control	
Wired alarm outputs	1 for siren command 12 V 0.5 A - 1 for self-powered siren 14 Vdc; 1 for on-board siren; R1 and R2 = programmable relays for various functions	
Control inputs	1 for connection of supplementary electronic/electromechanical actuator	
Radio system control	Continuous, simultaneous and programmable control of 2 working frequencies	
Event log	Last 200 events	
Timers	<ul style="list-style-type: none"> <li>- Programmable delayed activation - Programmable delay on each detector</li> <li>- General alarm direction of 3 cycles each of 3 minutes at intervals of 3 minutes</li> <li>- Programmable 24 h clock for activation control</li> </ul>	
Displays	Display of 2x16 characters, with possibility of naming each peripheral (label)	
Commands	Alphanumeric keypad, 20 keys	
Sound power	Alarm siren 106 dB + buzzer with low intensity signal function	
Acoustic signals	Recordable voice messages for main communication guidelines for the user	
Vocal synthesis	Vocal synthesis with 125 pre-recorded "phrases", available in the main languages	
Radio reception/transmission	Digital bidirectional communication, on dual band frequency (433 and 868 MHz)	
Radio range	100 m in open field free of disturbance or approx. 20 m inside buildings	
Wired connection	PSTN land line (also with broadband)	
GSM module*	Quad-band, GSM 850/900/1800/1900 MHz	
Operating temperature	-10 ÷ +40 °C	
Dimensions (LxDxH)	211x54x307 mm	
Weight	1.2 kg	

\*Only for HSCU1GC version.



The box that protects the control electronics rotates for easier wiring and access to the memory and SIM card on the GSM versions.

# Nice HSSO1/HSSOC Outdoor sirens



**Outdoor alarm siren with integrated flashing light, also on new Dual Band version via radio, with voice function.**

**The sound power of 116 dB**, dissuades the intruder, while the flashing light enables illumination of the area where the alarm trips.

The flashing light and adjustable sound confirm activation and deactivation of the control unit.

**Deterrent voice messages:** the surprise effect of the model with voice function HSSO1 does not disturb neighbours but discourages and deters intruders.

**Stylish and painstaking design:** box with antifoam design equipped with **protection against opening, detachment from wall, and break-in attempts.**

**HSSO1 siren via radio**, bidirectional, powered by Battery Pack.

**New version with built-in voice card.**

**HSSOC wired siren**, powered at 12 V by the control unit, with internal backup battery (not supplied).

Code	Description
<b>HSSO1</b>	Outdoor siren via radio, with integrated bidirectional and Dual Band voice board, powered by Battery Pack (supplied). Sound power 116 dB, with built-in flashing light
<b>HSPS1</b>	Battery Pack 9 V (12 Ah)

Code	Description
<b>HSSOC</b>	Outdoor siren for wired control units, powered at 230 Vac and lead battery (not supplied). Sound power 116 dB, with flashing light. Compatible with control units HSCU1GC and HSCU1C
<b>B12V-C</b>	12 V lead battery (2.2 Ah) necessary for siren Back-Up

## Technical specifications

Code	HSSO1	HSSOC
Power supply	Battery Pack 9 V (12 Ah), supplied	Wired 12 Vdc**
Average autonomy*	3 years	
Supervision	Approx. every 20 minutes	-
Sound power	116 dB at 1 m	
Radio reception/transmission	Digital bidirectional communication, on Dual Band frequency (433 and 868 MHz)	-
Range	100 m in open field free of disturbance or approx. 20 m inside buildings	-
Tamper alarm	Transmission of tamper alarm in event of opening of box and/or detachment from wall and/or violent break-in attempts	
Protection rating	IP 44	
Operating temperature	-25 ÷ +55 °C	
Dimensions (LxDxH)	211x66x307 mm	
Weight	2.5 kg	1.5 kg

\*It may vary according to the use and type of system. \*\*It requires a 12 V 2.2 Ah rechargeable battery which is not included.

# Nice HSSI Indoor siren

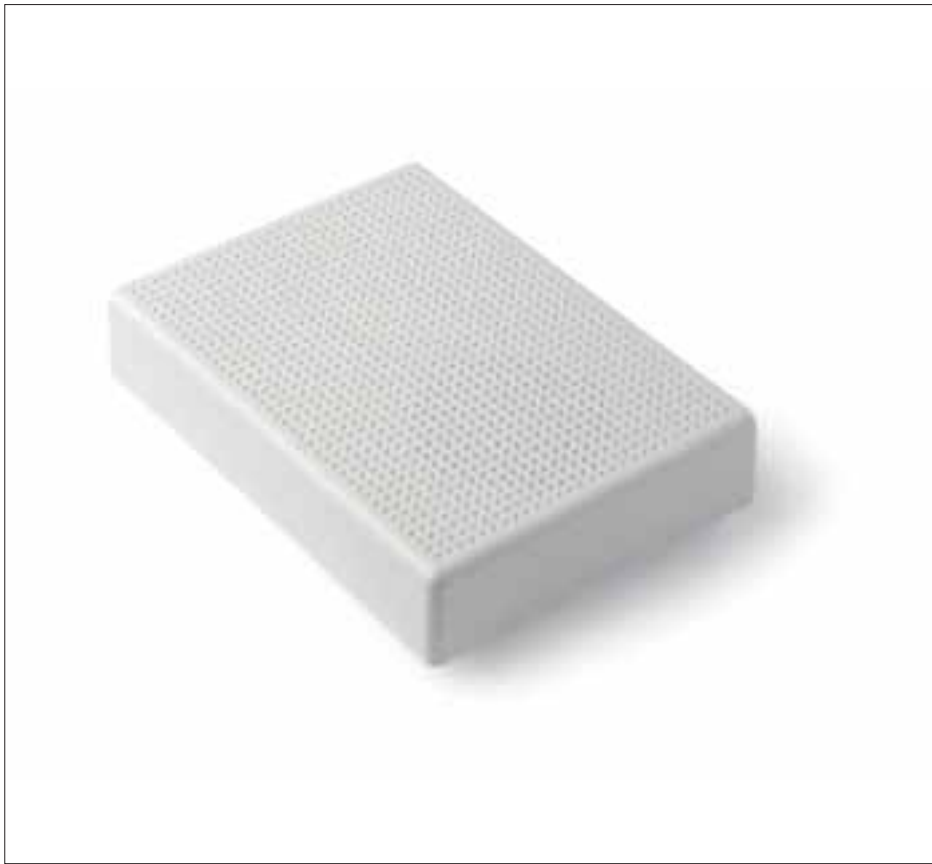

## Indoor alarm siren via radio.

**Wireless technology**, discreet design: easy installation, minimal visual impact. Can be wall-mounted or, thanks to the compact dimensions, installed in concealed locations.

**Highly deterrent sound power of 114 dB**, timed at three minutes and able to signal system activation/deactivation with low intensity signals (with mute function).

**Equipped with protection against opening.**

Code	Description
<b>HSSI</b>	Indoor siren via radio, battery-powered (supplied). Sound power 114 dB
<b>B1,5V-C</b>	Alkaline battery, 1.5 V size C

### Technical specifications

Code	HSSI
Power supply	3 alkaline batteries, 1.5 V size C, supplied
Autonomy	Approx. 2 years
Sound power	114 dB at 1 m
Radio reception	Digital communication at frequency of 433 MHz with quartz control
Radio range	100 m in open field free of disturbance or approx. 20 m inside buildings
Operating temperature	-10 ÷ +40 °C
Dimensions (LxDxH)	153x37x111 mm
Weight	700 g

# Nice Control systems

Just a click!

A single finger is all that's needed to control the alarm system and each automation, or automation groups.

The convenience of a home automation system at the cost of a single alarm system.

Why not?



Table lamp "Daruma" by Sergio Asili, 1968, kindly loaned by FontanaArte.

# Nice HSKPS Keypad



**Bidirectional Dual Band keypad, wall-mounted or portable for control of alarm system and automation control systems.**

**HSKPS is a keypad used to activate/deactivate the connected alarm control units and automations** with visual confirmation of operations and service indicators via leds or buzzer, to indicate conditions such as protected doors/windows left open and low battery signals.

Key to check system status.

**Safety and protection**

Antiduress function with deactivation under threat, with simultaneous dialling of telephone numbers.

**Programmable key with antipanic function** (activation of sirens and of calls) **or burglary alarm** (activation of calls) or programmable for control of an automation or other manual command.

Code	Description
<b>HSKPS</b>	Bidirectional Dual Band radio keypad, for control of alarm system and automation control systems, battery powered (not supplied)
<b>HSKCT</b>	Desktop support/anti-fall protection for HSKPS portable keypad
<b>B1,5V-A</b>	Alkaline battery, 1.5 V size AAA

**Technical specifications**

	<b>HSKPS</b>
Code	
Power supply	3 alkaline batteries, 1.5 V size AAA, supplied
Autonomy	Approx. 2 years
Display and controls	8 function control Leds and buzzer
Radio transmission	Digital communication on Dual Band frequency (433 and 868 MHz)
Radio range	100 m in open field free of disturbance or approx. 20 m inside buildings
Operating temperature	-10 ÷ +40 °C
Dimensions (LxDxH)	100x23x100 mm
Weight	180 g



# Nice HSTX8 Transmitter



**Radio transmitter, 8-channel, bidirectional 433 MHz, Rolling Code.**

**4 keys dedicated to the alarm system** for activation/deactivation and partial activation (programmable also for direct control of the HSTT receivers). Programmable key with emergency call or antipanic function (direct activation of sirens) or for control of alternative partial activation (B + C).

**4 programmable keys for control of the corresponding number of automations,** individual or groups, or other manual commands.

**Bidirectional:** confirmation of operations thanks to the optical feedback. After sending the commands “ON”, “OFF” and “Partial ON” (orange Led lit) the Led displays the result (green = OFF; red = ON or partial ON).

**Slim and ergonomic,** with provision for attachment to key-ring.

Code	Description
HSTX8	8-channel radio transmitter (4 channels for alarm systems and 4 for automation control), battery supplied
B3VC	Lithium battery 3 V (CR2032)

## Technical specifications

	HSTX8
Code	HSTX8
Power supply	Lithium battery 3 V (CR2032), supplied
Autonomy	Approx. 2 years
Frequency	433 MHz
Range	100 m in open field free of disturbance or approx. 20 m inside buildings
Radio reception/transmission	Digital bidirectional communication
Operating temperature	-20 ÷ +55 °C
Dimensions (LxDxH)	36x10x88 mm
Weight	27 g

# Nice HSTX4 Transmitter



**Radio transmitter, 4-channel, bidirectional 433 MHz, Rolling Code.**

**2 keys dedicated to alarm system** for activation/deactivation and 2 programmable keys with the functions of **alternative partial activation** (also programmable for direct control of HSTT receivers), **emergency call or antipanic** (direct activation or sirens).

**Bidirectional:** confirmation of operations with optic feedback after sending the commands "ON", "OFF" and "Partial ON" (orange Led lit) the Led displays the result (green = OFF; red = ON or Partial ON).

**Small and ergonomic,** with provision for attachment to key-ring.

Code	Description
HSTX4	4-channel radio transmitter for alarm systems, battery supplied
B3VC	Lithium battery 3 V (CR2032)

## Technical specifications

	HSTX4
Code	HSTX4
Power supply	Lithium battery 3 V (CR2032), supplied
Autonomy	Approx. 2 years
Frequency	433 MHz
Range	100 m in open field free of disturbance or approx. 20 m inside buildings
Radio reception/transmission	Digital bidirectional communication
Operating temperature	-20 ÷ +55 °C
Dimensions (LxDxH)	42x13x50 mm
Weight	16 g

# Nice Detectors and accessories

## Deterrence, protection, warning

Perimeter and volumetric monitoring can be modulated to meet all coverage requirements, inside and outside rooms, thanks to the vast range of sensors available.



# Nice HSDID11 Detector



**HSDID11 opening detector with magnetic contact via radio, Dual Band; indicates opening of doors and windows.**

**HSDID11 opening detector with magnetic contact via radio, Dual Band; indicates opening of doors and windows.**

Supervised magnetic contact for protection against intrusion through doors and windows. Fitted with two inputs (NC/NO or with pulse count function) to connect supplementary detectors, such as movement sensors for shutters.

**“Door open” signal function.**

Possibility of connecting flood detection sensor HSDIW01.

**Safe:** operates with a 9 V battery and is **protected against opening and removal.**

**Reliable:** signal well in advance of need to replace batteries, both locally via Leds and buzzers, and by transmission via radio to control unit.

Code	Description
<b>HSDID11</b>	Magnetic contact detector with input for second contact (NC/NO or pulse count); single or differentiated alarm complete with set of supports, battery supplied. Intruder sensor. White
<b>HSDID11CB</b>	Magnetic contact detector with input for second contact (NC/NO or pulse count); single or differentiated alarm complete with set of supports, battery supplied. Intruder sensor. Brown
<b>B9V-B</b>	Alkaline battery 9 V (GP1604A)

## Technical specifications

Code	HSDID11	HSDID11CB
Power supply	Alkaline battery 9 V (GP1604A), supplied	
Autonomy	Approx. 2 years	
Supervision	Approx. every 40 minutes	
Display and controls	Illumination of the Led confirms each alarm	
Radio transmission	Digital communication on dual band frequency (433 and 868 MHz)	
Radio range	100 m in open field free of disturbance or approx. 20 m inside buildings	
Operating temperature	-25 ÷ +55 °C	
Dimensions (LxDxH)	33x31x135 mm	
Weight	120 g	

# Nice HSDIM11 Detector



## HSDIM11 infrared detector with volumetric lens via radio, Dual Band.

- Supervised passive infrared detector with compact dimensions.
- Detects any movement in the protected area, up to 10 m through 90°.**
- Dual protection:** equipped with wired NC input for connection of magnetic contacts and/or detectors for shutters with differentiated alarms (volumetric/NC input).
- Adjustable:** possibility of adjusting coverage on two levels, up to 5 or 10 m.
- Safe:** operates with a 9 V battery and is protected against opening and removal.
- Reliable:** signal well in advance of need to replace batteries, both locally via Leds, and by transmission via radio to control unit.

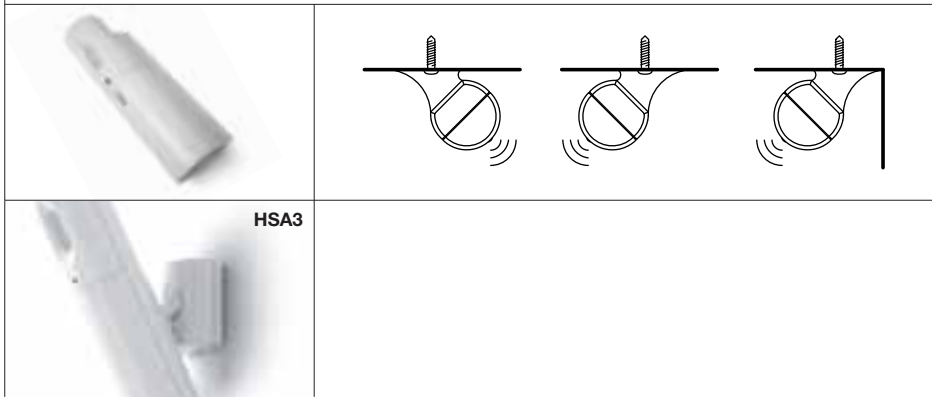

Code	Description
HSDIM11	Infrared detector with volumetric lens with input for second contact (NC or pulse count); single or differentiated alarm, complete with corner support and battery supplied
HSA3	Articulated arm (pack of 3 parts)
B9V-B	Alkaline battery 9 V (GP1604A)

### Technical specifications

Code	HSDIM11
Power supply	Alkaline battery 9 V (GP1604A), supplied
Autonomy	Approx. 2 years
Supervision	Approx. every 40 minutes
Display and controls	Illumination of the Led confirms each alarm
Inhibition of redundant alarms	2 minutes with retrigger
Radio transmission	Digital communication on Dual Band frequency (433 and 868 MHz)
Radio range	100 m in open field free of disturbance or approx. 20 m inside buildings
Operating temperature	-25 ÷ +55 °C
Dimensions (LxDxH)	33x31x135 mm
Weight	120 g

### Coverage area

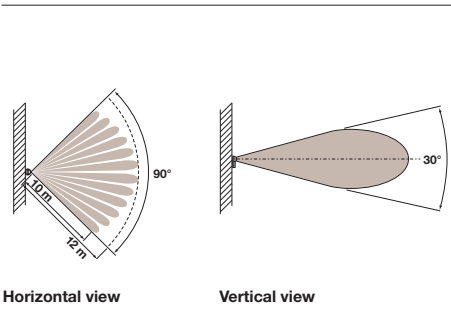



# Nice HSDIM12 Detector



**HSDIM12 infrared detector with vertical curtain lens, via radio, Dual Band, to protect doors and windows.**

Supervised volumetric curtain lens detector with compact dimensions for the protection of doors and windows, also outdoors (if protected) to signal movement in the narrow band in front of the sensor.

**Dual protection:** unique in its category, equipped with wired NC input for connection of magnetic contacts and/or detectors for shutters with differentiated alarms (volumetric/NC input).

**Adjustable:** possibility of adjusting coverage on two levels, up to 3 or 6 m.

**Safe:** operates with a 9 V battery and is **protected against opening and removal.**

Code	Description
<b>HSDIM12</b>	Infrared detector with curtain lens and input for second contact (NC or pulse count); single or differentiated alarm, battery supplied. White
<b>HSDIM12CB</b>	Infrared detector with curtain lens and input for second contact (NC or pulse count); single or differentiated alarm, battery supplied. Brown
<b>B9V-B</b>	Alkaline battery 9 V (GP1604A)

## Technical specifications

Code	HSDIM12	HSDIM12CB
Power supply	Alkaline battery 9 V (GP1604A), supplied	
Autonomy	Approx. 2 years	
Supervision	Approx. every 40 minutes	
Display and controls	Illumination of the Led confirms each alarm	
Inhibition of redundant alarms	2 minutes with retrigger	
Radio transmission	Digital communication on Dual Band frequency (433 and 868 MHz)	
Radio range	100 m in open field free of disturbance or approx. 20 m inside buildings	
Operating temperature	-25 ÷ +55 °C	
Dimensions (LxDxH)	33x31x135 mm	
Weight	120 g	

## Coverage area

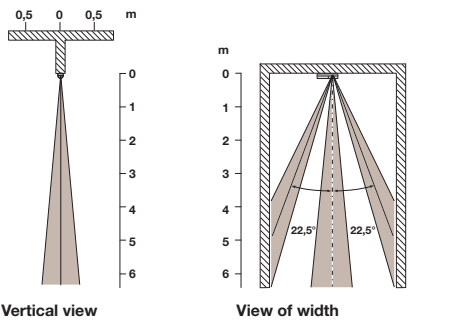

# Nice HSDIM21 Detector



**HSDIM21 supervised infrared detector with volumetric lens, via radio, Dual Band.**

Infrared volumetric movement detector, with adjustment of sensitivity and infrared pulses.

**Detects any movement in the protected area, up to 12 m through 120°.**

**Self-protected against opening and removal.**

**Reliable:** signal well in advance of need to replace batteries, both locally via Leds, and by transmission via radio to control unit.

Code	Description
<b>HSDIM21</b>	Volumetric infrared detector, wireless, batteries supplied
<b>HSA3</b>	Articulated arm (pack of 3 parts)
<b>B1,5V</b>	Alkaline battery, 1.5 V size AA

## Technical specifications

	HSDIM21
Code	HSDIM21
Power supply	3 alkaline batteries, 1.5 V size AA, supplied
Autonomy	Average estimated at longer than 2 years
Supervision	Approx. every 40 minutes
Display and controls	Illumination of the Led confirms each alarm. Buzzer for acoustic signals
Technology used	Passive infrared detection
Adjustments	4 range levels, temperature compensation
Inhibition of redundant alarms	2 minutes with retrigger
Radio transmission	Digital communication on Dual Band frequency (433 and 868 MHz)
Radio range	100 m in open field free of disturbance or approx. 20 m inside buildings
Operating temperature	-25 ÷ +55 °C
Dimensions (LxDxH)	78x47x152 mm
Weight	320 g

## Coverage area

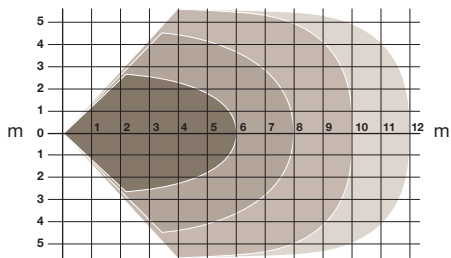

Infrared sensor sensitive area - **horizontal view**

# Nice HSDIM22 Detector



**HSDIM22 dual technology volumetric detector via radio.**

Supervised dual technology (infrared + microwave) volumetric movement detector, with adjustment of sensitivity and infrared pulses.

**Detects any movement in the protected area, up to 12 m through 90°.**

**Self-protected against opening and removal.**

**Maximum safety in movement detection:** dual control of intrusion for maximum limitation of improper alarms thereby improving safety performance.

**Reliable:** signal well in advance of need to replace batteries, both locally via Leds, and by transmission via radio to control unit.

Code	Description
HSDIM22	Wireless dual technology volumetric detector, batteries supplied
HSA3	Articulated arm (pack of 3 parts)
B1,5V	Alkaline battery, 1.5 V size AA

## Technical specifications

Code	HSDIM22
Power supply	3 alkaline batteries, 1.5 V size AA, supplied
Autonomy	Average estimated at longer than 2 years
Supervision	Approx. every 40 minutes
Display and controls	Two-colour Led for IR, MW and alarm confirmation signals. Buzzer for acoustic signals
Technology used	Passive infrared detection confirmed by Doppler effect microwave detector
Adjustments	4 range levels, temperature compensation; microwave detector sensitivity and activation time
Inhibition of redundant alarms	2 minutes with retrigger
Radio transmission	Digital communication on Dual Band frequency (433 and 868 MHz)
Radio range	100 m in open field free of disturbance or approx. 20 m inside buildings
Operating temperature	-25 ÷ +55 °C
Dimensions (LxDxH)	78x47x152 mm
Weight	390 g

## Coverage area

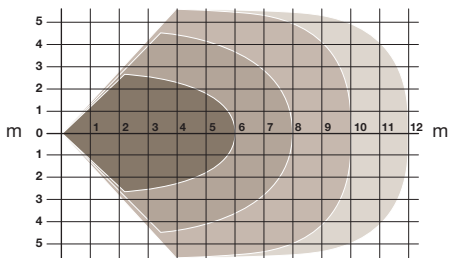

Infrared sensor sensitive area - horizontal view

# Nice HSDOM21 and HSDOM22 Outdoor detectors



**Dual technology volumetric detector, via radio, for outdoor use.**

**Self-protected against opening and removal.**

**Maximum safety** in movement detection: dual control of intrusion for maximum limitation of improper alarms thereby improving safety performance, with virtual immunity to transit of small animals thanks to the special lens profile.

**Reliable:** signal well in advance of need to replace batteries, both locally via Leds or acoustic "Beeps", and by transmission via radio to control unit.

**HSDOM21 supervised dual technology (infrared + microwave) volumetric movement detector;** with adjustment of sensitivity and infrared pulses.

**Detects any movement in the protected area, up to 12 m through 90°.**

**HSDOM22 supervised dual technology volumetric detector via radio.**

**Detects any movement in the protected area, up to 20 m through 90°.**

**Efficient barrier effect** thanks to the special PIR lens that enables a thin infrared beam up to 20 m.

Test and temperature compensation function.

Code	Description
HSDOM21	Wireless dual technology volumetric detector, batteries supplied. Outdoor, up to 12 m through 90°
HSDOM22	Wireless dual technology volumetric detector, batteries supplied. Outdoor, up to 20 m through 90°
HSA3	Articulated arm (pack of 3 parts)
B1,5V	Alkaline battery, 1.5 V size AA

## Coverage area

### HSDOM21

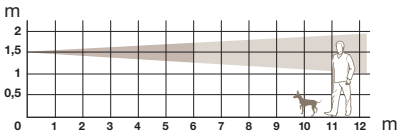

Infrared sensor sensitive area - lateral view

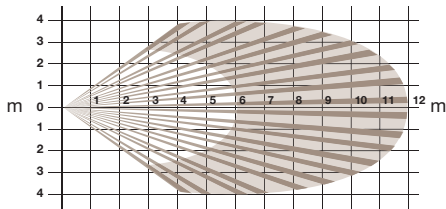

Infrared sensor sensitive area - horizontal view

### HSDOM22

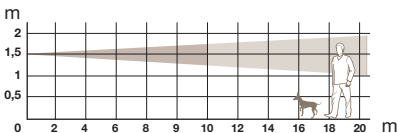

Infrared sensor sensitive area - lateral view

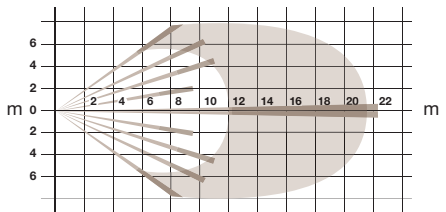

Infrared sensor sensitive area - horizontal view

**Technical specifications**

Code	HSDOM21	HSDOM22
Power supply	3 alkaline batteries, 1.5 V size AA, supplied	
Autonomy	Average estimated at longer than 2 years	
Supervision	Approx. every 40 minutes	
Display and controls	Two-colour Led for IR, MW and alarm confirmation signals. Buzzer for acoustic signals	
Technology used	Passive infrared detection confirmed by Doppler effect microwave detector	
Adjustments	2 range levels, temperature compensation; microwave detector sensitivity and activation time	
Inhibition of redundant alarms	2 minutes with retrigger	
Radio transmission	Digital communication on dual band frequency (433 and 868 MHz)	
Radio range	100 m in open field free of disturbance or approx. 20 m inside buildings	
Protection rating	IP 65	
Operating temperature	-25 ÷ +55 °C	
Dimensions (LxDxH)	84x49x158 mm	
Weight	430 g	



# Nice HSDID01 Detector



## HSDID01 microphone detector via radio of glass breakage.

**Equipped with microphone device which detects the sound frequencies produced by glass breakage:** thus useful for integrating the protection of doors and windows such as shop windows.

**Protection against opening of the housing;** operates with one standard 9 V battery with a lifetime of approx. 2 years, depending on conditions.

Alarm log via Leds (flashing for 60 s).

Code	Description
<b>HSDID01</b>	Microphone detector of glass breakage, battery supplied
<b>B9V-B</b>	Alkaline battery 9 V (GP1604A)

### Technical specifications

Power supply	Alkaline battery 9 V (GP1604A), supplied
Autonomy	Approx. 2 years
Display and controls	System running test and alarm via Leds
Radio transmission	Digital communication on Dual Band frequency (433 and 868 MHz)
Radio range	100 m in open field free of disturbance or approx. 20 m inside buildings
Operating temperature	-10 ÷ +40 °C
Dimensions (LxDxH)	108x44x80 mm
Weight	166 g

# Nice HSDIW01 Detector



## HSDIW01 flood detector sensor.

**Detects the presence of liquids** at a set height, activating transmission to the control unit and/or radio receiver.

**Easy to install:** connected with 2 wires to the terminal NO of the HSDID11 detector.

Code	Description
<b>HSDIW01</b>	Flood detector sensor

### Technical specifications

Power supply	Requires connection to sensor HSDID11
Operating temperature	-20 ÷ +55 °C
Dimensions (LxDxH)	35x15x80 mm
Weight	120 g

# Nice HSDIS01 Detector



## HSDIS01 Dual Band smoke detector via radio.

**Detects any concentrations of fine volatile powder** caused by incipient fires, by photo-optical analysis of the air, with local alarm signal by means of a buzzer and the on-board Led, and simultaneous transmission of alarm signal via radio to the control unit and/or receiver.

**Control and self-diagnostics:** equipped with a device to indicate any operating faults caused by dust in the air and consequent deposits on the sensitive element.

Alarm signal via Led and buzzer.

Code	Description
HSDIS01	Smoke detector, battery supplied
B9V-B	Alkaline battery 9 V (GP1604A)

### Technical specifications

Power supply	Alkaline battery 9 V (GP1604A), supplied
Autonomy	Approx. 2 years
Supervision	Approx. every 40 minutes
Display and controls	Signalling via Leds and acoustic buzzer
Protected volume	Standard 6x6 m 3 m height; larger or non-square rooms require more detectors
Radio transmission	Digital communication on dual band frequency (433 and 868 MHz)
Radio range	100 m in open field free of disturbance or approx. 20 m inside buildings
Operating temperature	-20 ÷ +55 °C
Dimensions (LxDxH)	106x60 mm
Weight	100 g

# Nice HSTXS1 Transmission board



**HSTXS1 radio transmission board for alarms, universal,** for alarm signals to the control units and receivers in the NiceHome System range.

**The compact dimensions and battery-powered operation** make this transmission module **the ideal solution to integrate any detector with control units and receivers in the NiceHome System range.**

It can be housed in wired detectors and send alarm and tamper signals via radio.

It also sends low battery and supervision signals to the control unit.

Code	Description
HSTXS1	Radio transmission board for alarms, universal

## Technical specifications

Code	HSTXS1
Power supply	1 alkaline battery LR14 9V, supplied
Autonomy	Depends on consumption of detector used and the number of alarm signals transmitted. (Board consumption: 5 uA on stand by - 40 mA in alarm conditions)
Supervision	Approx. every 40 minutes
Checks	Battery discharged
Radio transmission	Digital communication on Dual Band frequency (433 and 868 MHz)
Radio range	100 m in open field free of disturbance or approx. 20 m inside buildings
Operating temperature	-20 ÷ +55 °C
Dimensions (LxDxH)	98x26x20 mm
Weight	40 g

# Nice HSTT2 Miniaturised receiver



**HSTT2 miniaturised recessed receiver, 433 MHz, for control of electrical loads and motors for the automation of shutters.**

HSTT2L can be used alongside any electric switch/switching device, with a load up to 3 A 230 V, for management via radio of commands sent by the NiceHome system for turning on lights, heating and irrigation systems, boilers and all Nice automations for gates, garage doors, awnings and shutters (HSTT2N).

**Ultra-compact:** installable in confined spaces or recessed in a standard 503 box, this device is compatible with any type of front plate, safeguarding the aesthetics of installation.

Input for connection of an external wired switch.

Code	Description
HSTT2L	1-channel miniaturised radio receiver to control electric loads
HSTT2N	2-channel miniaturised radio receiver to control electric motors in the two directions (open, close) for rolling shutters and blinds

## Technical specifications

Code	HSTT2L	HSTT2N
Power supply	120 or 230 Vac, 50/60 Hz, limits: 100 ÷ 255 Vac	
Maximum output power	3 A	
Radio transmission	Digital communication at frequency of 433 MHz with quartz control	
Operating temperature	-20 ÷ 55 °C	
Dimensions (LxDxH)	18x33x40 mm	
Weight	20 g	

# Nice HSRE12 Interface



Code	Description
HSRE12	Dual Band receiver for expansion via radio of cable systems. 32 radio peripherals that can be memorised, 16 cable outputs, 4 of which for technical signals

## HSRE12 Dual Band radio receiver interface for expansion of wired systems.

Dual Band radio receiver for the expansion of wired alarm systems by means of radio devices in the NiceHome System range (detectors, control units, keypads and transmitters).

**Maximum installation flexibility: the ideal solution to expand the protection area to outside areas difficult to access with wiring** (e.g. garages, porticoes), facilitating installation especially in the case of expanding an existing system.

The receiver is fitted with 16 voltage-free relay outputs:

- 12 outputs for switching alarm radio signals sent by detectors and commands sent by keypads and transmitters;
- 4 outputs for switching technical alarms (tamper, low battery and detector supervision) and signals of possible radio disturbance.

**Compatible** with all radio equipment and peripherals in the NiceHome System range, HSRE12 identifies, memorises and supervises up to 32 devices:

- indoor and outdoor presence detectors;
- magnetic contacts for doors and windows;
- technical detectors: flooding and smoke;
- keypads and remote controls (for remote control of electrical devices, automations and lighting).

12 Vdc power supply from control unit, or other device connected to the receiver.

**Facilitated wire connections** via easily accessible terminal boards.

**Maximum safety** guaranteed by the continuous supervision of peripherals and signalling of any malfunctions via the 16 Led indicators available, memorising the operation of each output and performing complete checks and permanent tests of the system. The antiscanner function checks for the presence of possible radio disturbance.

Signals via Leds and buzzer, with adjustable levels and mute function.

### Technical specifications

Code	HSRE12
Power supply	12 Vdc
Absorption	60 mA
Displays	16 Led
Radio receiver	Dual Band 433 Mhz, 868 Mhz
Radio range	100 m in open field free of disturbance or approx. 20 m inside buildings
Device memory capacity	32 (Nice Home System encoding)
Outputs	16 outputs with voltage-free contacts (12 alarm signals + 4 fault signals) - NC/NO - monostable, bistable or timed
Operating temperature	-10°C ÷ +40°C
Protection rating	IP 32
Dimensions (LxDxH)	161x110x30 mm
Weight	400 gr

# Nice HSRT Radio Repeater



## HSRT radio signal repeater/amplifier, 230 V.

**Ideal for difficult environments**  
where the radio range is reduced due to long distances and/or internal partitions in special materials (reinforced concrete or stone), HSRT receives and repeats on Dual Band frequency all the radio signals typical of a NiceHome alarm system, enabling significant improvements to range.

**Flexible:** equipped with a power failure indicator and two voltage free inputs (one NO and one NC) for wired connections of other sensors.  
All events are transmitted to the control unit.

Code	Description
HSRT	Radio signal repeater/amplifier, 230V, supplied with back-up battery
B6V-A	Lead battery 6 V (1.2 Ah)

### Technical specifications

Code	HSRT
Power supply	230 Vac
Backup power supply	With rechargeable lead battery 6 V 1.2 Ah (supplied)
Autonomy in event of power failure	Approx. 3 days
Displays	Green Led to indicate power ON - Red Led to indicate transmission and system activation
Radio reception/transmission	Digital bidirectional communication, on Dual Band frequency (433 and 868 MHz)
Radio range	100 m in open field free of disturbance or approx. 20 m inside buildings
Operating temperature	-10 ÷ +40 °C
Dimensions (LxDxH)	170x52x93 mm
Weight	1.2 kg



# Nice HSMO Teleservice Modem



## HSMO Teleservice - Telemanagement modem for HSCU control units.

**Remote control:** by means of the Teleservice modem connected to a land line and local PC the installer has remote control of the NiceHome HSCU control units, to read the event log and perform all programming and modification procedures by phone as if on location.

HSMO is **simple to use** and fundamental for the advanced installer, to improve customer services, avoiding burdensome and costly on-site intervention.

Code	Description
HSMO	Modem for HSCU control units complete with programming software and cable for direct PC-Modem connection; optional Back-Up battery (not included)
B6V-A	Lead battery 6 V (1.2 Ah) with Back-Up function (optional)
HSA1	Cable and software for direct Control unit-PC connection

### Technical specifications

Code	HSMO
Power supply	230 Vac, 50/60 Hz
Absorbed power	< 0.9 W on stand by; < 4 W during battery recharging
Backup power supply	With rechargeable lead battery 6 V 1.2 Ah (supplied)
Autonomy in event of power failure	Approx. 3 days according to intensity of use
Interfaccia PSTN	Connettore RJ11
USB interface	Type B connector, USB compatible rev.1.1
Protection rating	IP40 (with container intact)
Operating temperature	-10 ÷ 40 °C
Dimensions (LxDxH)	162x120x83 mm (cables not included)
Weight	700 g

# Nice

Concept  
**Wurbs**

Product Design  
**Roberto Gherlenda**

Printed by  
**AGCM**

# The Nice Idea

Improving people's quality of life simplifying everyday's activities.

As one of the most important names in the field of Home Automation at international level, Nice develops, produces and merchandises alarm and automation systems for gates, garage doors, barrier gates, awnings, rolling shutters and solar screens for residential, commercial and industrial buildings.

Nice offers you the security to get in and out freely, satisfying your need for comfort with its functional and beautifully designed products, to allow you to fully enjoy your home.



NiceLoveEarth

Nice cares for the environment.  
Using natural paper it avoids excessive  
use of raw materials and forest exploitation.  
Waste is reduced, energy is saved  
and climate quality is improved.

**Nice**

**Nice SpA**  
Oderzo TV Italia  
Ph. +39.0422.85.38.38  
Fax +39.0422.85.35.85  
info@niceforyou.com

Find out more about Nice  
products and services on the website:  
**[www.niceforyou.com](http://www.niceforyou.com)**